

HYDRAULIC VALVE - HLR 7955A

This assembly is a two position, three way **Normally Closed**, pilot supply pressure operated, spring return, 10,000 PSI, flow control valve that has a manual operate (By-Pass) Handle. A Pilot Supply pressure of 80 PSI is required for controlling hydraulic pressure of 10,000 PSI.

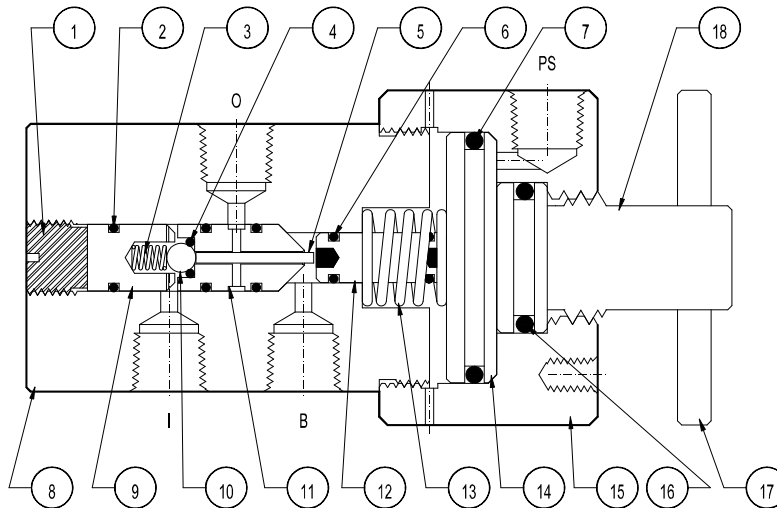

BILL OF MATERIAL

ITEM	PART NAME	PART NUMBER	MATERIAL
1.	Screw	7954	316SS
2.	O-Ring (3)	AS-012V95	Viton
3.	Spring	.210x.375x22	316SS
4.	O-Ring	AS-008A	AFLAS
5.	Pin	.078x.875	316SS
6.	O-Ring (2)	AS-010V75	Viton
7.	O-Ring	AS-223V75	Viton
8.	Body	7953	316SS
9.	Seal	7898A	316SS
10.	Ball	7/32TC	Tungsten Carbide
11.	Lower Seat	7897B	316SS
12.	Upper Seat	7895B	316SS
13.	Spring	.72x1x35	302SS
14.	Piston	7952	316SS
15.	Cap	7957	316SS
16.	O-Ring	AS-212V75	Viton
17.	Handle	.25"x 2.5" Tube	316SS
18.	By Pass Screw	7956AP	316SS

FEATURES

- Dimensions: 2.500" Dia. x 5.250" L.
 - Working Pressure: Pilot Supply - 250 PSI Max.
Hydraulic Supply - 10,000 PSI Max.
 - Connections: 1/4" - 18 NPT.
 - Weight: 4.5 lbs.
 - Bolt Holes: 2 Places - 1/4"-20 UNC on a 1 3/4" bolt hole circle.
 - Upper Seat: Item #12 is reversible.
- NOTE: Lower Seat has special AS-008T (Teflon) O-Ring installed in it.**